

Replacing and purchasing consumable parts

The lid unit, inner lid gasket, valve, clear cup, clear cup outer lid, and clear cup outer lid gasket are consumable parts. (These parts may be damaged as they come in contact with heat and steam during use.) Check once a year for damage/deterioration. If a part is badly stained or loose, replace it with a new one purchased from one of the following places.

- The dealer where you purchased this product
- Tiger customer service (see "Contact" below)

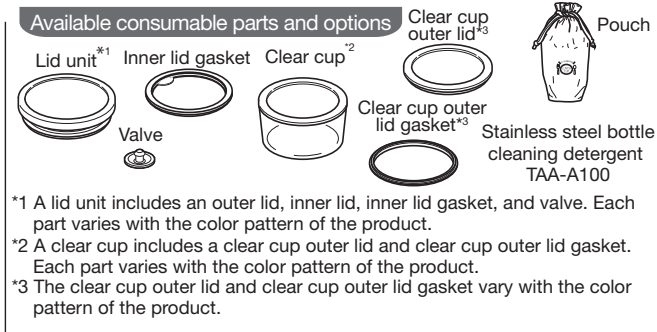

Before contact customer service

The utmost measures have been taken to ensure the quality of this product. Should the product be defective, however, check the troubleshooting measures listed on pages 12 and 13. If the defect persists, contact your dealer and provide the following information.

1. Product name
2. Model number (written on the sticker on the underside of the product)
3. Description of trouble (As detailed as possible)
4. Purchase date

Feel free to send any questions or comments about this product to the shop where you purchased it.

Note: For the purpose of performance improvement, designs, specifications and parts shown in this publication are subject to change without notice.

Contact



TIGER CORPORATION

Head Office: 3-1 Hayami-cho, Kadoma City, Osaka 571-8571, Japan
 URL : <http://www.tiger.jp/global.html>

TIGER HANBAI (H.K.) CO.,LTD.

Rm. 1006B, 10/F., Join-in Hang Sing Centre, 71 - 75 Container Port Road, Kwai Chung, N.T.

Tel: (852) 2418-0912 Fax: (852) 2418-0911

JAPAN TIGER CORPORATION OF U.S.A.

2730 Monterey Street, Suite 105 Torrance, CA 90503

Tel: (310) 787-1985 Fax: (310) 787-1986

EMAIL: info@japantigercorp.com

Please note that the contact name, phone number, and address are subject to change.

Stainless Steel Cup

Lunch Cup

Instructions

Thank you for purchasing a "TIGER" Stainless Steel Cup. Please read the instructions completely before use. Keep these instructions for future reference.

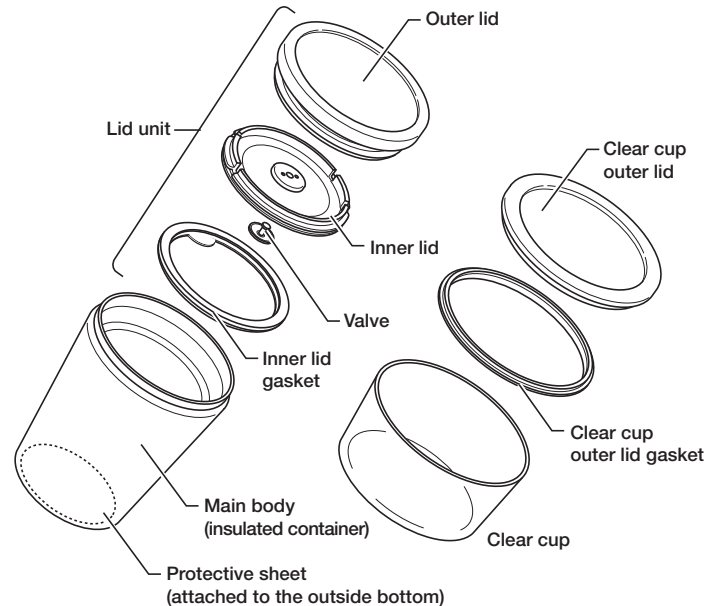

*Make sure that all parts are present before use.

Safety Precautions

Do not remove the caution sticker on the product or the sticker on the bottom.

These stickers indicate safety precautions that should be strictly observed to prevent any injuries

Keep out of reach of children. Do not allow children to play with the product.

There is a risk of burns or injuries.

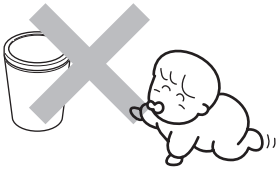

Drink slowly when the product contains hot food/beverages.

There is a risk of burns. (Due to the heat insulating effect, the outside of the bottle does not get hot even when hot contents are poured out.)

Do not put dry ice or carbonated beverages in the product.

The air pressure inside the product may increase, causing the lid unit to become stuck or prone to shattering. Contents may also be at risk of bursting out.

Do not place the product near stoves, open flames, or other sources of extreme heat.

There is a risk of burns or deformation or discoloring of the product.

Consume food/ beverages that is kept inside the product as soon as possible (within 6 hours).

Do not store raw foods for a long period of time as they may spoil.

Clean the product immediately after use.

The contents may decay or spoil. Spoilage can create gases that raise the air pressure inside the product, causing the lid unit to become stuck or prone to shattering. Contents may also be at risk of bursting out.

Rinse the inside of the product well, even if you are going out, for example, and don't have time to wash it thoroughly.

Mold, rust, or holes may appear or the product may become otherwise damaged or deformed.

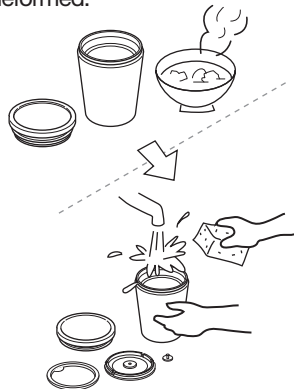

Do not store foods including dairy products or cold soup without cooking them thoroughly.

The contents may decay or spoil.

(Smoothies and similar cold dessert items are excluded.)

Do not heat the product in a microwave oven.

There is a risk of injury or failure due to sparks.

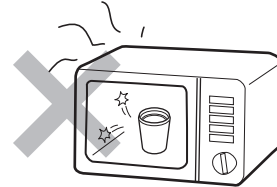

When you want to put heated food in the clear cup, be sure to cool it down in advance.

The contents may decay or spoil.

Do not pour soup into the clear cup.

This is not a completely sealed container.

Contents may leak if the cup is inclined or turned upside down.

Be sure to set the lid unit in proper position.

Contents may leak and cause soiling or skin burns.

Do not fill the product above the liquid capacity line shown below.

If the contents exceed the specified line, they may leak or overflow, potentially causing burns.

Liquid capacity line inside

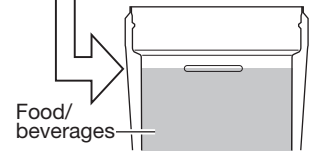

Do not touch the brim or spout of the product with a hot tea kettle spout.

The product may fall over, causing burns or injuries to the skin, or a scratch or deformation to the product.

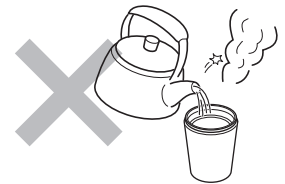

or burns.

Do not open the lid when the product is tilted or placed near the face.

Pouring hot matter into the product increases the internal air pressure. This may cause the contents to burst out and scatter, potentially causing burns.

Do not use the product if its ability to retain heat declines.

Hot food/beverages can make the product very hot, potentially causing burns.

Do not use the product in a moving vehicle.

This may result in burns or soiling of clothes or of the interior of the vehicle. (Using the product while you are driving is very dangerous, as you may be distracted.)

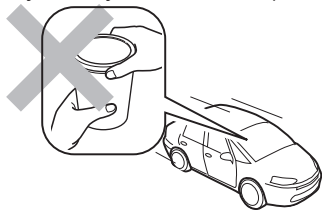

Do not expose the clear cup to direct sunlight for a long time.

The cup may become discolored or otherwise deteriorate.

Do not use the product for any purposes other than keeping food/beverages warm or cold.

Do not knock over, drop or expose the product to excessive shocks.

There is a risk of damage to the product, a reduction of its heat- or cold-retention ability, rusting, flaking of the exterior paint, or leakage of contents.



Do not disassemble or attempt to repair the product by yourself.

There is a risk of failure or accident.

Do not put the product in a freezer.

Contents may leak or the product may be damaged.

Do not use the clear cup for making ice.

The product may be damaged or deformed.

Do not leave the product in a pouch or bag for a long time.

The storage conditions may change and there is a risk of rust or odors.



Do not use chlorine-based bleaches to wash the product.

This may cause rust or a hole on the product. Use of stainless steel bottle cleaning detergent TAA-A100 is recommended.

Do not scrape or rub the patterns or stickers on the surface of the product using your nails or a hard object.

The exterior paint may come off.

Do not remove the protective sheet on the underside of the product.

Removing this may reduce the product's heat- or cold-retention ability.

Keep the main body and clear cup in an upright position at all times.

Contents may leak.

Keep the main body and clear cup in upright position when putting the product in a pouch or bag.

Contents may leak if the product is laid horizontally.



Do not swing the product while holding the pouch strap.

The product may hit someone or something, resulting in damage or injury.

Do not put the product in the pouch or bag while the outside of the main body or clear cup is wet.

There is a risk of rust, odor, or soiling.

Do not use the pouch while it is wet.

The color may transfer to your clothes or elsewhere.

Do not use chlorine- or oxygen-based bleach to wash the pouch.

The color may fade, discolor, or deteriorate.

Do not use a laundry machine or clothes dryer, as the pouch may shrink.

Some of the color of the contents may remain on the inner lid, clear cup and clear cup outer lid. This does not affect the performance and safety.

Due to the structure of the product, tiny water droplets may be formed on the clear cup and clear cup outer lid when humidity around the product is high.

How to Use

Example of use

For rice, soup, etc.

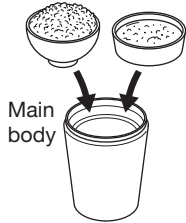

Offers heat/cold retention.

For salads, cereal, etc.

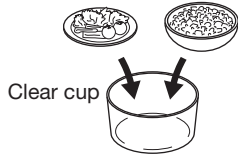

Does not offer heat/cold retention.
Do not pour any liquid.

1

Remove the lid unit.

First!

Before the first use

- Clean the product by referring to “How to Clean”.
- Check that the retainer ring, inner lid, inner lid gasket, and valve are attached to the lid unit.

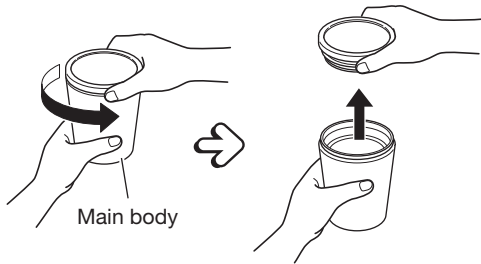

2

To keep your food/beverages warm or cold longer, pour hot (or cold) water into the main body, and let it sit for one or two minutes to allow the inside of the main body to heat (or cool).

- Discard the hot (or cold) water after preheating (or precooling).

5

3

Pour hot (or cold) food/beverages into the main body.

- Do not fill the jar above the liquid capacity shown below.

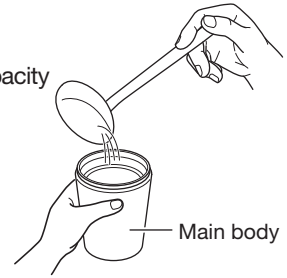
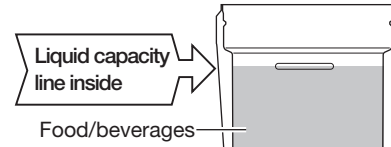

4

Keep the main body in an upright position when you close the lid unit.

- Securely close the lid unit so that it cannot be turned.

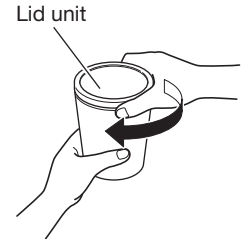

5

Remove the clear cup outer lid.

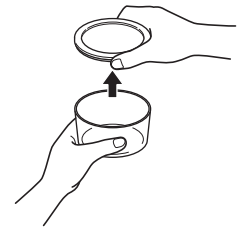

Caution

- Do not lift the clear cup holding only the clear cup outer lid. The clear cup may fall.

6

6

Fill the clear cup with food and then securely close the clear cup outer lid.

Caution

- Do not pour soup into the clear cup. The contents may leak.
- Put heated food in after it has cooled down.
- The clear cup does not offer heat/cold retention.
- When putting in food with strong odors, vinegar, oils, darkly pigmented food (brightly colored vegetables such as spinach, pickled radish, and shiso), wrap them in plastic wrap. There is a risk of odor and color transfer.

7

Put the main body and clear cup in the pouch.

We recommend using the main body for foods/beverages that need to be kept warm, such as rice or soup, and the clear cup for foods that don't need to be kept warm, such as salad or cereal.

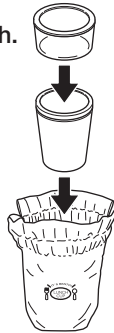

Caution

- Do not put the product in the pouch when it is wet or place it upside down.

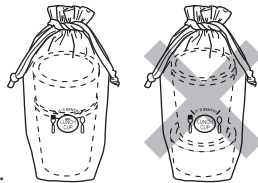

8

Pull the straps to close the pouch.

- Be sure to close the pouch when carrying the product.

9

Remove the lid unit and enjoy your food/beverages.

Caution

- Clean after every use.

10

After use, keep the main body upright and securely close the lid unit and the outer lid.

Securely close the inner lid and outer lid.

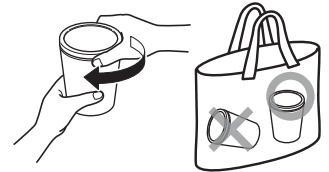

Caution

- Keep the main body upright all the time, even in your bag. Content may leak if the product is laid horizontally.

Heating the clear cup in a microwave oven

Remove the clear cup outer lid, and then heat the cup in a microwave oven.

Caution

- Do not heat the clear cup with the clear cup outer lid attached.
- Do not heat the main body in a microwave oven.
- Do not heat the clear cup if it is empty.
- Do not heat food with a high oil or sugar content for a long period of time.
- Do not heat the clear cup using anything other than a microwave oven.
- Do not heat the clear cup using the oven/grill function of a combination microwave oven.
(After using the oven/grill function for other dishes, allow the chamber to cool down before inserting the clear cup.)

How to Clean

Before the first use

You may notice an unusual odor coming from the material of the product. In this case, clean the product by following the steps below.

- ① Pour hot water into the main body, and then securely close the lid unit.
- ② Hold the main body and gently shake it several times to rinse the inside thoroughly. (Do not shake it excessively. The hot water may burst out, potentially causing burns.)
- ③ Discard the hot water, and then clean each part.



- ◆ After using the product, be sure to clean it on the same day.
- ◆ Use dishwashing detergent.
- ◆ Use a soft sponge or cloth.
- ◆ Clean the components frequently to prevent odor.

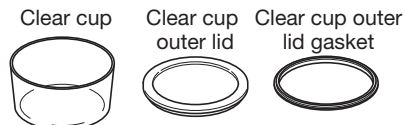
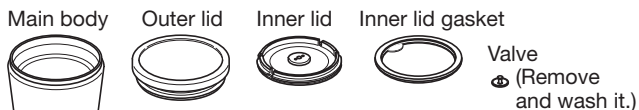

- ① Wash each part using a sponge with diluted detergent water or lukewarm water, and then thoroughly rinse it with water. (Wash the main body and lid unit in running water. Soaking is not recommended.)
- ② Wipe the water off with a dry cloth and dry the parts thoroughly.



After washing the product by hand, dry it thoroughly.
 Note: • Do not use chlorine- or oxygen-based bleach to wash the pouch.
 • Do not use a laundry machine or clothes dryer, as it may cause the pouch to shrink.

If an odor remains on the gasket

Depending on the contents, the odor may remain on the gasket. In this case, leave the gasket in boiling water for approximately 30 minutes to reduce the odor. If the odor is still noticeable, purchase a new gasket (sold as an optional part).

Caution

- After washing the entire main body, immediately wipe the water off with a dry cloth. Otherwise, water droplet marks may remain on the main body, or the main body may rust and cause soiling.
- Do not use thinners, cleansers, chlorine-based bleaches, chemical cloths, metallic scrubbing brushes, or nylon scrubbing brushes.
- Parts other than the gasket should not be put in a dishwasher or dish dryer, nor in boiling water.
- Be sure to attach the inner lid, inner lid gasket, valve, clear cup outer lid and clear cup outer lid gasket.
- When the product is not used for a long period of time, thoroughly wash out stains and then dry it.

Attaching and removing the inner lid

To remove

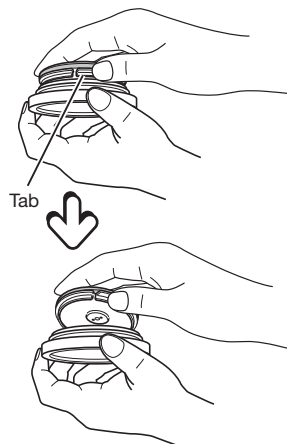

Hold the tab of the inner lid with your fingers and remove it slowly.

To attach

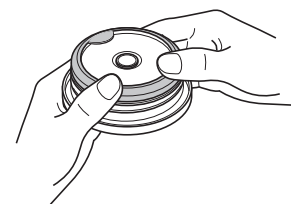

Insert the inner lid completely from the top until you hear a clicking sound.

Attaching and removing the inner lid gasket and valve

Caution

- When attaching the inner lid gasket and valve, make sure that they are correctly positioned and oriented. The contents may leak.

To remove

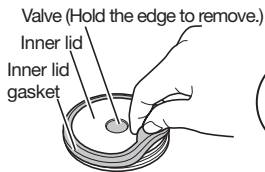

Pull out the inner lid gasket and remove it slowly.

To attach

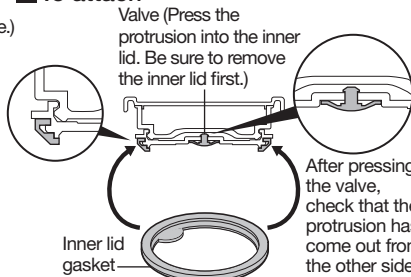

When attaching the inner lid gasket, make sure to fit it completely onto the inner lid while checking the position and direction.

Attaching and removing the clear cup outer lid gasket

To remove

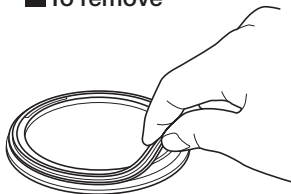

Pull out the clear cup outer lid gasket from the groove and remove it slowly.

To attach

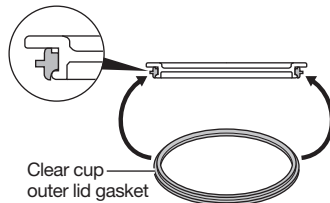

Insert it completely to the end. The clear cup outer lid gasket can be set in any orientation.

If a pigment remains in the clear cup

Depending on the contents, some pigment may remain in the clear cup.

In this case, bleach the clear cup with diluted oxygen-based bleach (stainless steel bottle cleaning detergent TAA-A100), and then thoroughly rinse it with water.

Problem

Check

Solution

Food/beverages leaks from the product.

▶ Did you attach the inner lid gasket and valve properly?

▶ Securely set the inner lid gasket and valve. ➡ P.10

▶ Did you securely set the inner lid, inner lid gasket, and valve?

▶ Securely set the inner lid gasket and valve. ➡ P.7-10

▶ Is there any damage to the inner lid, inner lid gasket, or valve?

▶ If there is any damage to a part, purchase a new one and replace it. ➡ Back cover

▶ Did you attach the inner lid gasket and valve in the right places and with the right orientations?

▶ Securely set the inner lid gasket and valve. ➡ P.10

▶ Did you try to put in too much food/beverages?

▶ Put appropriate amount of food/beverages. ➡ P.2-5

▶ Is there any food/beverages (solids) attached to the inner lid gasket or valve?

▶ Did you use a dishwasher or dish dryer, or leave the product in boiling water? ➡ P.10

Product is not retaining heat or cold.

▶ Was the product dropped, or did it suffer a hard impact? ➡ P.3

▶ Did you apply a strong force to the inside of the main body or use a metallic scrubbing brush or the like when cleaning the product? ➡ P.10

▶ Is there too little food/beverages in the product? Food/beverages may not be kept warm or cold if there isn't enough of it.

▶ Food/beverages may not be kept warm if it was not initially heated enough.

▶ Food/beverages may not be kept warm or cold if the product is used in a harsh environment, such as in a cold region or in a high-temperature environment.

Problem	Check	Solution
An odor is coming out from inside of the main body, inner lid or gasket, or valve.	<p>The first time you use the product, you may notice an unusual odor coming from the material of the product.</p> <p>Is there any adhering stain or did you leave food/beverages in the product for a long time?</p>	<p>Clean the product by referring to "Before the first use". ➡P.9</p> <p>Clean the product. ➡P.9 · 14</p>
The lid unit does not open.	Did you leave food/beverages in the product for a long time?	There is a risk that gas produced by food/beverages spoilage has raised the air pressure inside the product. Contact your dealer.
There are lines and waves on some plastic parts.	These were created during resin molding and do not affect the quality of the product.	
Tiny water droplets have formed on the clear cup and clear cup outer lid.	Due to the structure of the product, tiny water droplets may form when the humidity around the product is high.	
A slight rattling sound is produced when the product is shaken.	The main body of the product incorporates metallic foil that improves heat or cold retention. When sections of foil rub each other, it produces sound. This is not a defect and does not affect product performance.	

Countermeasure against staining inside the main body

For red, rust-like spots or rough areas

Such staining can be caused by minerals in water, such as calcium, magnesium, and iron. It is recommended to clean with citric acid, which is available at supermarkets and drugstores.

- (1) Dilute the citric acid (approximately 10 g) in lukewarm water, and then pour it into the main body.
- (2) After a few hours have elapsed, wash the main body with a soft brush and then thoroughly rinse it.
- (3) Dry the main body completely.

For food/beverages stains

It is recommended to use stainless steel bottle cleaning detergent TAA-A100 (option).

◆ Model number: TAA-A100, 10 g x 4 packages

Specifications

Size	0.3 Type
Actual capacity	0.32 L / @@ oz
Liquid capacity line	0.3 L / @@ oz
Heat retention (6 hours)	Greater than 50°C / @@°F
Cold retention (6 hours)	Less than 12°C / @@°F
External dimensions*1	10.0 x 10.0 x 16.2 cm (W/D/H)
Weight*1	0.33 kg

*1 Approximate values

- Notes: 1. Heat retention has been calculated under the condition of adding hot water at 95°C±1°C / 203°F±2°F and leaving it in a room temperature of 20°C±2°C / 68°F±4°F for 6 hours.
2. Cold retention has been calculated under the condition of adding cold water at 4°C±1°C / 39°F±2°F and leaving it in a room temperature of 20°C±2°C / 68°F±4°F for 6 hours.
3. The actual capacity is the volume of water that can be stored in the product when the lid unit is closed. This is not the "Liquid capacity line" volume described in "Safety Precautions".